

# KONGRESS -ZENTRUM KREUZ



## CONGRESS DOCUMENTATION

At the Congress Centre Kreuz, you will find professional event facilities for business and private occasions, all under one roof at over 600m<sup>2</sup>, centrally located in the heart of the city of Bern. Whether a workshop, a meeting, a concert or a family celebration. Thanks to the numerous possible combinations, we can offer you rooms for 10 to 240 people. Of course, modern infrastructure and technology are also included. We offer attractive workshop packages for groups of 15 or more. Choose a suitable offer from three possible variants.

All our rooms have been named after personalities who are either directly connected to our house or have a firm place in the history of Bern. Feel the creativity of the most famous Bernese painters Albert Anker and Ferdinand Hodler in the halls named after them or learn more about the founder of the Blue Cross and his connection to our property in the Bovet hall.

Aperitif, standing buffet, workshop lunch or banquet? You can choose the culinary setting from our flexible catering offer. We have compiled detailed information on the banquet rooms as well as the current menu suggestions for aperitifs, standing buffets and banquets in separate documents.

You need advice or you have any questions? We have extensive experience in organising congresses, workshops and banquets. We will be happy to create a specially tailored offer to fit your needs. Our flexible team will be happy to help and advise you before and during your events. We are looking forward to your visit.

# OVERVIEW OF THE CONFERENCE ROOMS / PRICES

These prices are valid for congresses, conferences, meetings, etc.

For examinations, exhibitions and events with concert seating without aperitif, lunch or dinner, a surcharge of 10% will be added to the room rent.

Rooms	Location	m <sup>2</sup>	Persons	½ Day	1 day
Fischer	1 <sup>ST</sup> BASEMENT	88	22 - 70	285.00	410.00
Hodler	1 <sup>ST</sup> BASEMENT	138	39 - 120	415.00	680.00
<b>Fischer / Hodler</b>		<b>226</b>	<b>120 - 240</b>	<b>700.00</b>	<b>1090.00</b>
Bovet	1 <sup>ST</sup> FLOOR	114	33 - 100	490.00	760.00
Tavel	2 <sup>ND</sup> FLOOR	45	16 - 35	175.00	270.00
Steiger	2 <sup>ND</sup> FLOOR	44	16 - 35	175.00	270.00
Haller	1 <sup>ST</sup> FLOOR	41	14 - 30	165.00	250.00
Anker	2 <sup>ND</sup> BASEMENT	70	22 - 60	220.00	335.00
Bubenberg	2 <sup>ND</sup> BASEMENT	30	10 - 20	105.00	160.00
Erlach	2 <sup>ND</sup> BASEMENT	30	10 - 20	105.00	160.00
<b>Anker / Bubenberg / Erlach</b>		<b>130</b>	<b>39 - 100</b>	<b>395.00</b>	<b>635.00</b>

All prices in CHF and incl. VAT

## The following times are considered to be ½ day:

08.00 – 12.00 o'clock

13.00 – 17.00 o'clock

18.00 – 23.00 o'clock

## The following times are considered to be 1 day:

08.00 – 17.00 o'clock

13.00 – 23.00 o'clock

## Questions?

Do not hesitate to contact our Congress-Team: Tel. +41 31 329 96 06 or [info@kongresszentrumkreuz.ch](mailto:info@kongresszentrumkreuz.ch)

# SEATING

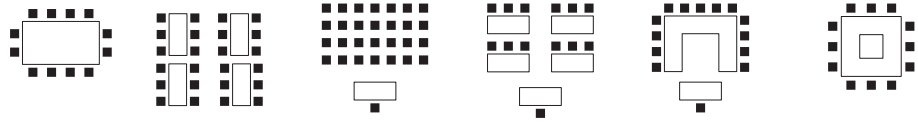

Rooms	Block	Banquet	Concert	Seminar	U-shape	O-shape
Fischer	22	50	70	40	30	36
Hodler	*	96	120	60	39	48
<b>Fischer / Hodler</b>	<b>*</b>	<b>220</b>	<b>240</b>	<b>120</b>	<b>*</b>	<b>*</b>
Bovet	*	96	100	60	33	42
Tavel	16	*	35	18	20	22
Steiger	16	*	35	24	20	22
Haller	16	*	30	16	14	16
Anker	22	48	60	30	30	36
Bubenberg	10	*	20	12	14	16
Erlach	10	*	20	12	14	16
<b>Anker / Bubenberg / Erlach</b>	<b>*</b>	<b>96</b>	<b>100</b>	<b>60</b>	<b>39</b>	<b>48</b>

\* This type of seating is not recommended or possible.

The maximum number of persons does not include a board table. Depending on the room, there are board tables available for 2 – 8 speakers. Other types of seating such as work stations or individual tables on request.

## Questions?

Do not hesitate to contact our Congress-Team: Tel. +41 31 329 96 06 or [info@kongresszentrumkreuz.ch](mailto:info@kongresszentrumkreuz.ch)

# TECHNICAL EQUIPMENT / INFRASTRUCTURE

The desired seating and a flip chart are included in the room rental fee.

We are at your disposal for technical instructions.

Item	½ Day	1 day
WLAN	Free	Free
Loudspeaker system with wireless microphone (headset or hand microphone)	80.00	160.00
Additional wireless microphone (headset or hand microphone)	60.00	60.00
Beamer	60.00	120.00
LED-Screen 65 inch / diameter 164 cm (rooms: Tavel, Haller, Steiger 82 inch)	60.00	120.00
Interactive moderator screen	80.00	160.00
Visualiser incl. a beamer or a LED screen	90.00	180.00
Visualiser	60.00	120.00
Laptop	60.00	120.00
Meeting - OWL (for hybrid meetings)	60.00	120.00
Large speakers for laptop	30.00	30.00
Recording device	50.00	50.00
Additional flip charts	15.00	15.00
Pinboard	15.00	15.00
Moderator's tool case	35.00	35.00
Laser pointer	Free	Free
Block and a ballpoint pen (per person)	3.00	3.00
Mobile stage elements, 1 to 6 elements (per piece)	30.00	30.00
Mobile stage elements, 7 to 12 elements (per piece)	20.00	20.00

All prices in CHF and incl. VAT

**The following times are considered to be ½ day:**

08.00 - 12.00 o'clock

13.00 - 17.00 o'clock

18.00 - 23.00 o'clock

**The following times are considered to be 1 day:**

08.00 - 17.00 o'clock

13.00 - 23.00 o'clock



Maximum flexibility following your needs: the Fischer and Hodler halls can be used individually or combined into a single room. With this room, you have our largest hall at your disposal for up to 240 people. The permanently installed stage (the height of 80cm) can be extended by the height-adjustable mobile stage elements.



### Catering

- Coffee breaks
- Aperitif
- Standing buffets
- Banquets

### Technical Equipment

- Beamer
- Loudspeaker system with a microphone
- other technical equipment:  
see price list

Rooms	Location	m <sup>2</sup>	Persons	½ Day	1 day
Fischer	1 <sup>ST</sup> BASEMENT	88	22 - 70	285.00	410.00
Hodler	1 <sup>ST</sup> BASEMENT	138	39 - 120	415.00	680.00
<b>Fischer / Hodler</b>		<b>226</b>	<b>120 - 240</b>	<b>700.00</b>	<b>1090.00</b>

All prices in CHF and incl. VAT

# FISCHER / HODLER

# 1<sup>ST</sup> BASEMENT

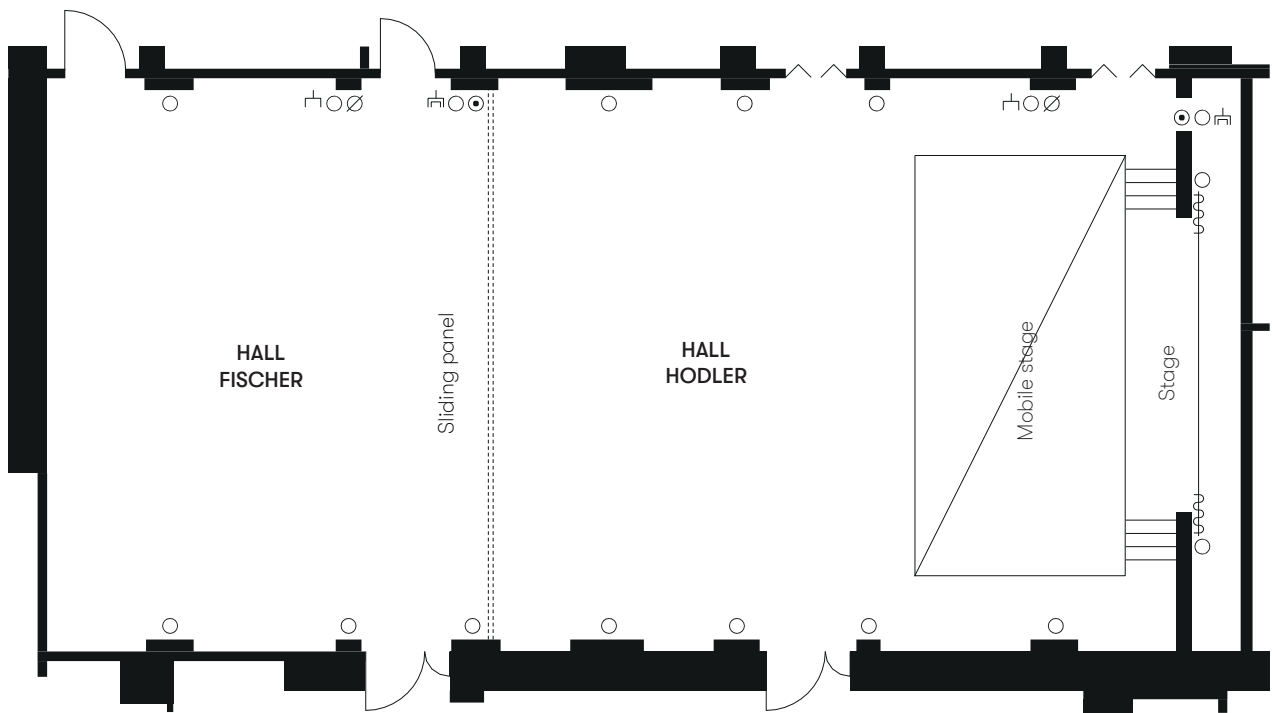

- Socket 3-fold, 220 V
- ⌚ Telephone
- ⊙ Microphones

**Fischer**  
 Length: 10.7 m  
 Width: 8.2 m  
 Height: 4.2 m

**Hodler**  
 Length: 12.9 m  
 Width: 10.7 m  
 Height: 4.2 m

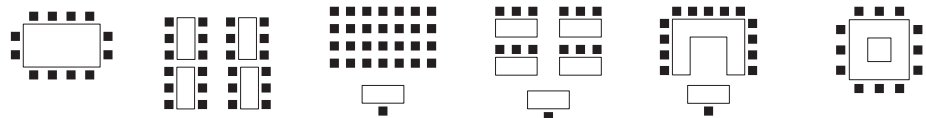

Rooms	Block	Banquet	Concert	Seminar	U-shape	O-shape
Fischer	22	50	70	40	30	36
Hodler	*	96	120	60	39	48
<b>Fischer / Hodler</b>	<b>*</b>	<b>220</b>	<b>240</b>	<b>120</b>	<b>*</b>	<b>*</b>

\* This type of seating is not recommended or possible.

## Questions?

Do not hesitate to contact our Congress-Team: Tel. +41 31 329 96 06 or [info@kongresszentrumkreuz.ch](mailto:info@kongresszentrumkreuz.ch)

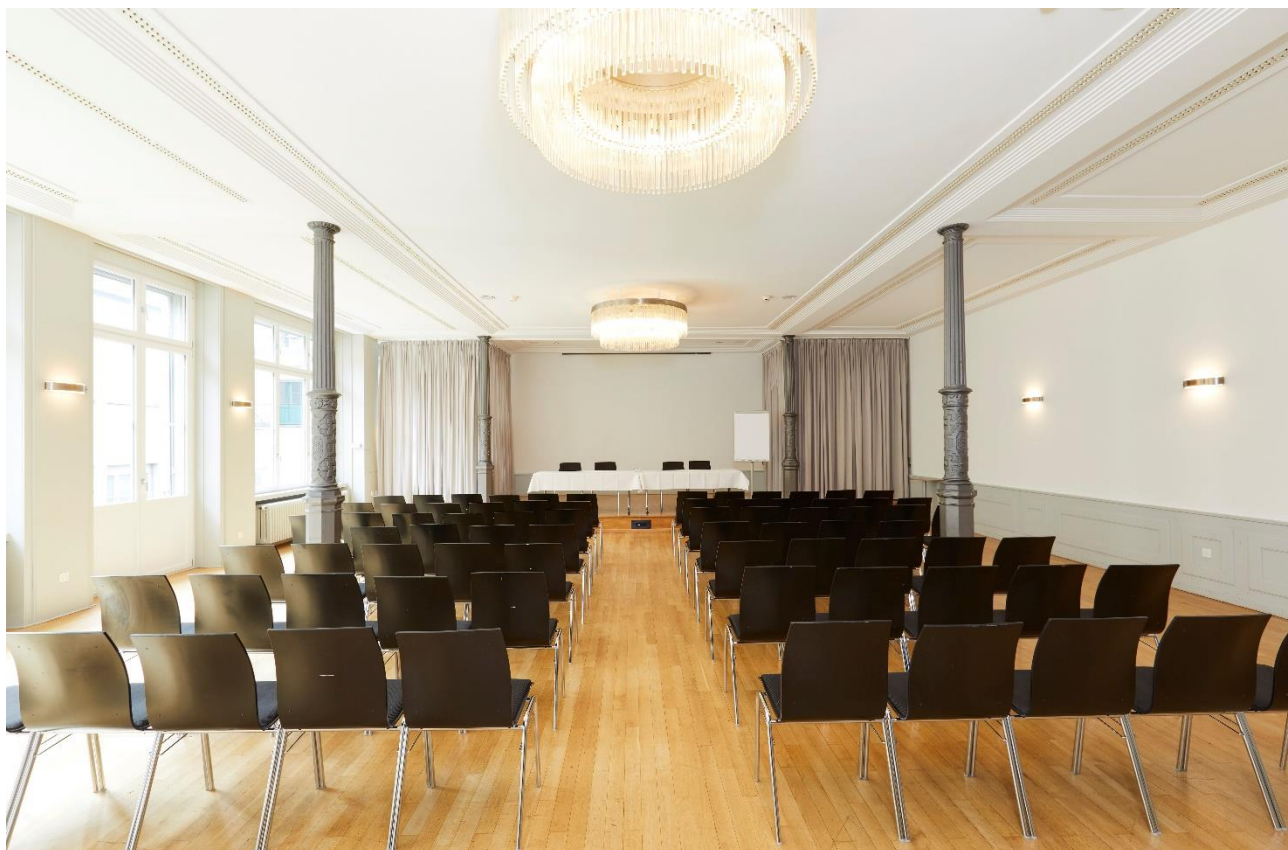

The tasteful Bovet Hall is the showpiece of our conference rooms. It has a generous floor plan and a stage at the head end (the height of 40cm). The particularly bright and friendly room has its own foyer and gives every occasion a stylish touch. The room is suitable for conferences and workshops as well as banquets and receptions.



### Catering

- Coffee breaks
- Aperitif
- Standing buffets
- Banquets

### Technical Equipment

- Beamer
- Loudspeaker system with a microphone
- other technical equipment:  
see price list

Rooms	Location	m <sup>2</sup>	Persons	½ Day	1 day
Bovet	1 <sup>ST</sup> FLOOR	114	33 - 100	490.00	760.00
Bovet incl. Foyer		146	64 - 140		
Stage		33			

All prices in CHF and incl. VAT

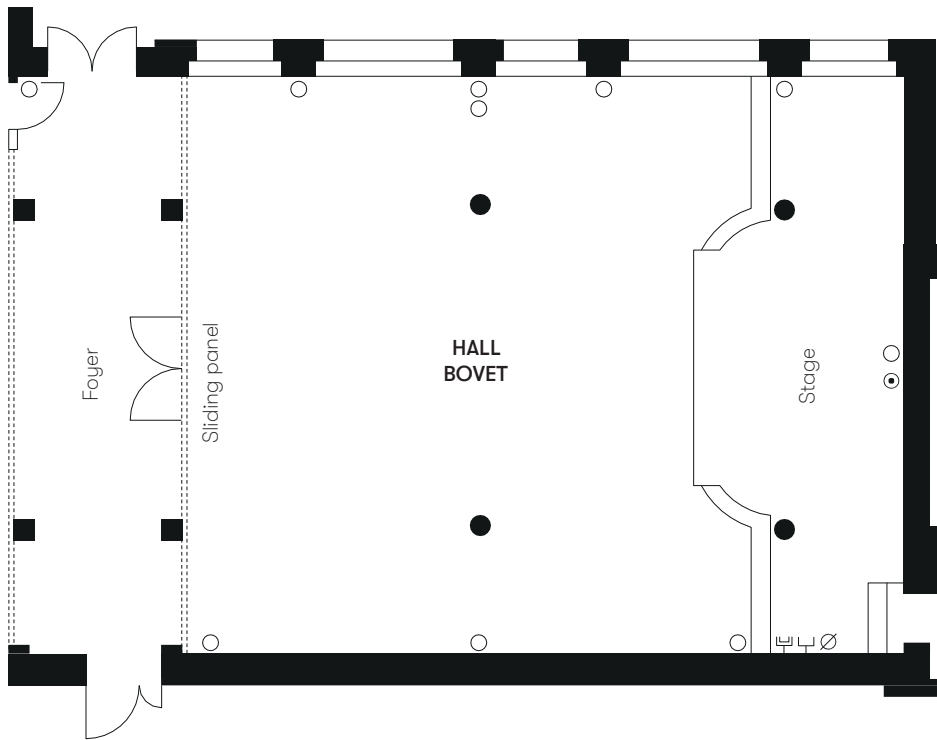

- Socket 3-fold, 220 V
- ⊥ Telephone
- ⊙ Microphones
- Pillar

Length: 13.5 m  
 Width: 10.9 m  
 Height: 3.5 m

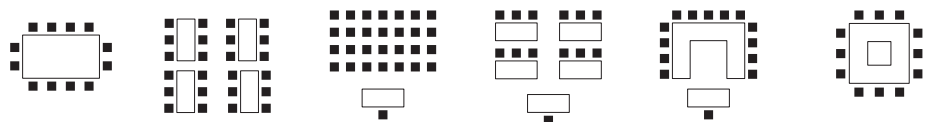

Rooms	Block	Banquet	Concert	Seminar	U-shape	O-shape
Bovet	*	96	100	60	33	42
Bovet incl. Foyer	*	120	140	*	*	*

\* This type of seating is not recommended or possible.

### Questions?

Do not hesitate to contact our Congress-Team: Tel. +41 31 329 96 06 or [info@kongresszentrumkreuz.ch](mailto:info@kongresszentrumkreuz.ch)



# TAVEL

# 2<sup>ND</sup> FLOOR



Whether creative group work or media conferences - in the Tavel Hall you and your guests are in good hands at the best location. If you would like an aperitif afterwards, we will be happy to serve it right in the hall. Depending on the seating, it offers a space for meetings, workshops or conferences containing from 16 to 35 participants.

### Catering

- Coffee breaks
- Aperitif

### Technical Equipment

- LED screen 65 inch
- other technical equipment: see price list

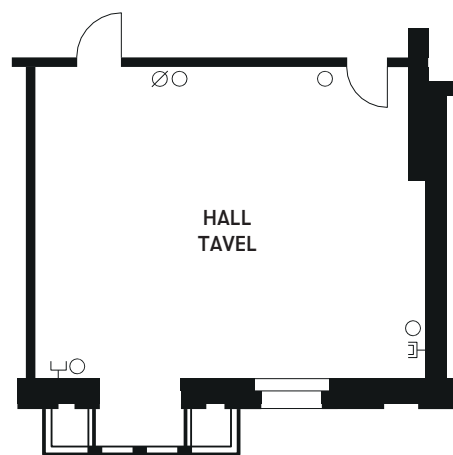

Room	Location	m <sup>2</sup>	Persons	½ Day	1 day
Tavel	2 <sup>ST</sup> FLOOR	45	16 - 35	175.00	270.00

All prices in CHF and incl. VAT

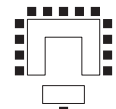
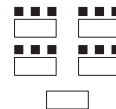
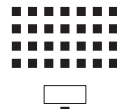
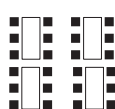
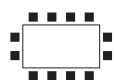

Room	Block	Banquet	Concert	Seminar	U-shape	O-shape
Tavel	16	*	35	18	20	22

\* This type of seating is not recommended or possible.

### Questions?

Do not hesitate to contact our Congress-Team: Tel. +41 31 329 96 06 or [info@kongresszentrumkreuz.ch](mailto:info@kongresszentrumkreuz.ch)

# STEIGER

## 2<sup>ND</sup> FLOOR



A peace oasis in the middle of the city: The Steiger Hall offers you an undisturbed atmosphere for important meetings, workshops and rewarding debates. The south-facing window front allows plenty of daylight into the room. Depending on the seating, it offers a space for meetings, workshops or conferences containing from 16 to 35 participants.

### Catering

- Coffee breaks
- Aperitif

### Technical Equipment

- LED screen 82 inch
- other technical equipment: see price list

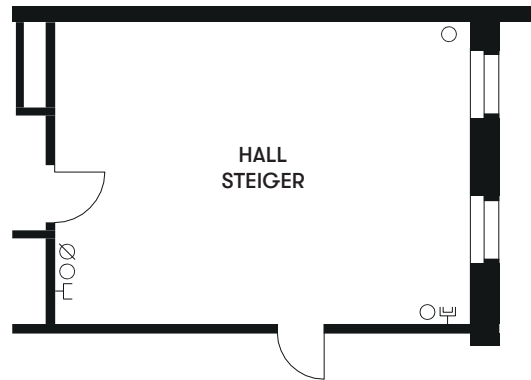

Room	Location	m <sup>2</sup>	Persons	½ Day	1 day
Steiger	2 <sup>ND</sup> FLOOR	44	16 - 35	175.00	270.00

All prices in CHF and incl. VAT

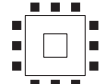
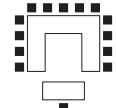
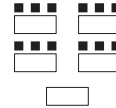
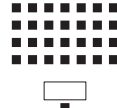
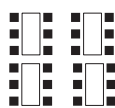
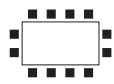

Room	Block	Banquet	Concert	Seminar	U-shape	O-shape
Steiger	16	*	35	24	20	22

\* This type of seating is not recommended or possible.

### Questions?

Do not hesitate to contact our Congress-Team: Tel. +41 31 329 96 06 or [info@kongresszentrumkreuz.ch](mailto:info@kongresszentrumkreuz.ch)

# HALLER

# 1<sup>ST</sup> FLOOR



The bright and friendly Haller Hall is the ideal setting for conferences, training courses and workshops in smaller groups. Let yourself be inspired to new ideas in a stylish atmosphere, develop exciting projects and exchange new insights.

### Catering

- Coffee breaks
- Aperitif

### Technical Equipment

- LED screen 65 inch
- other technical equipment:  
see price list

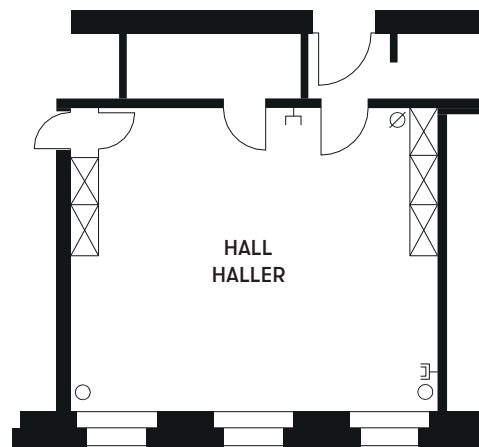

Room	Location	m <sup>2</sup>	Persons	½ Day	1 day
Haller	1 <sup>ST</sup> FLOOR	41	14 - 30	165.00	250.00

All prices in CHF and incl. VAT

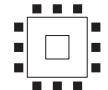
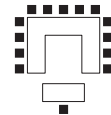
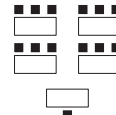
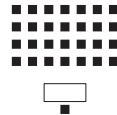
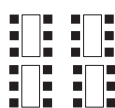
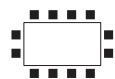

Room	Block	Banquet	Concert	Seminar	U-shape	O-shape
Haller	16	*	30	16	14	16

\* This type of seating is not recommended or possible.

### Questions?

Do not hesitate to contact our Congress-Team: Tel. +41 31 329 96 06 or [info@kongresszentrumkreuz.ch](mailto:info@kongresszentrumkreuz.ch)



The three rooms Anker, Bubenberg and Erlach in the second basement level can be combined in almost any way thanks to the flexible sliding panels. As individual rooms they are ideally suited for group work, as a total room they offer space for up to 100 people, depending on the seating.

### Catering

- Coffee breaks

### Technical Equipment

- Beamer
- other technical equipment: see price list



Rooms	Location	m <sup>2</sup>	Persons	½ Day	1 day
Anker	2 <sup>ND</sup> BASEMENT	70	22 - 60	220.00	330.00
Bubenberg	2 <sup>ND</sup> BASEMENT	30	10 - 20	105.00	160.00
Erlach	2 <sup>ND</sup> BASEMENT	30	10 - 20	105.00	160.00
<b>Anker/Bubenberg/Erlach</b>		<b>130</b>	<b>39 - 100</b>	<b>395.00</b>	<b>635.00</b>

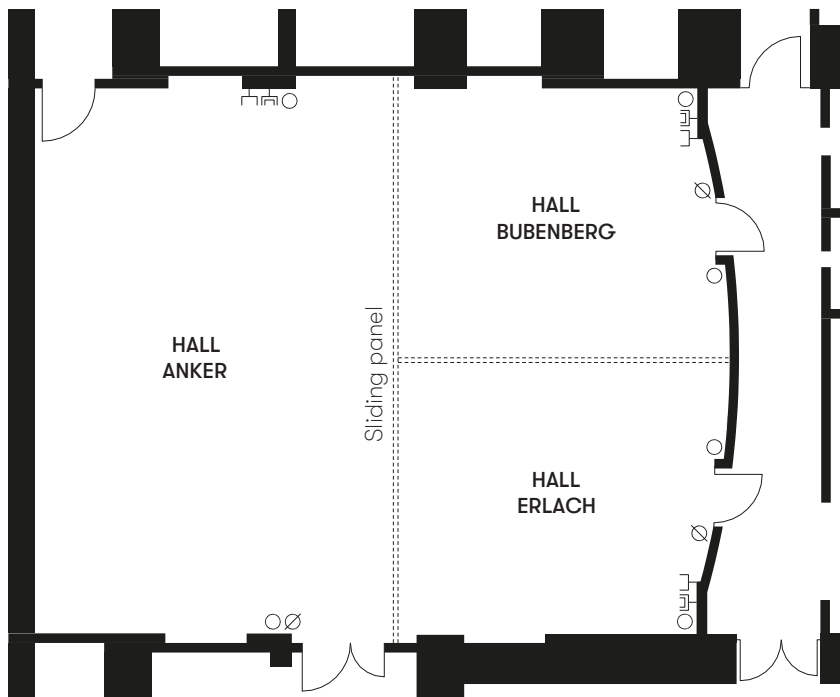

- Socket 3-fold, 220 V
- ⌚ Telephone

### Anker

Length: 10.3 m  
 Width: 6.8 m  
 Height: 2.9 m

### Bubenberg/Erlach

Length: 5.7 m  
 Width: 5.1 m  
 Height: 2.9 m

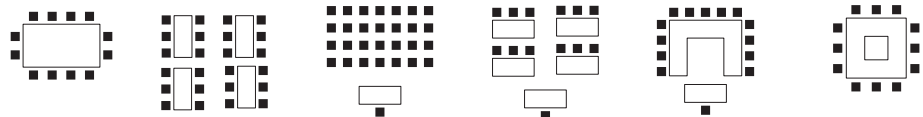

Rooms	Block	Banquet	Concert	Seminar	U-shape	O-shape
Anker	22	48	60	30	30	36
Bubenberg	10	*	20	12	14	16
Erlach	10	*	20	12	14	16
<b>Anker/Bubenberg/Erlach</b>	<b>*</b>	<b>96</b>	<b>100</b>	<b>60</b>	<b>39</b>	<b>48</b>

\* This type of seating is not recommended or possible.

### Questions?

Do not hesitate to contact our Congress-Team: Tel. +41 31 329 96 06 or [info@kongresszentrumkreuz.ch](mailto:info@kongresszentrumkreuz.ch)

# WORKSHOP FLAT

Our attractive workshop packages can be booked **for 15 persons or more** and include the desired congress room, aids and catering. Choose a suitable offer from three possible variants.

---

## DAY FLAT RATE AT CHF 85.00 PER PERSON

- Conference room (allocated by us)
  - Desired seating arrangement
  - 1 x beamer and 1 flipchart
  - Free WLAN
  - Mineral water during the seminar
  - Morning coffee break with coffee, tea, fruit juice, fruits and croissants
  - Coffee break in the afternoon with coffee, tea, fruit juice, fruits and cake
  - 2-course workshop menu (compiled by our chef)
  - Mineral water and 1 coffee for lunch
- 

## MORNING FLAT RATE AT CHF 65.00 PER PERSON

- Conference room (allocated by us)
  - Desired seating arrangement
  - 1 x beamer and 1 flipchart
  - Free WLAN
  - Mineral water during the seminar
  - Morning coffee break with coffee, tea, fruit juice, fruits and croissants
  - 2-course workshop menu (compiled by our chef)
  - Mineral water and 1 coffee for lunch
- 

## AFTERNOON FLAT RATE AT CHF 47.00 PER PERSON

- Conference room (allocated by us)
  - Desired seating arrangement
  - 1 x beamer and 1 flipchart
  - Free WLAN
  - Mineral water during the seminar
  - Coffee break in the afternoon with coffee, tea, fruit juice, fruits and cake
  - Followed by appetisers 4 pieces per person (prepared by our chef)
  - Orange juice and mineral water for aperitif
- 

### Questions?

Do not hesitate to contact our Congress-Team: Tel. +41 31 329 96 06 or [info@kongresszentrumkreuz.ch](mailto:info@kongresszentrumkreuz.ch)

# BREAKFAST WORKSHOPS

For a lively start to the day: Enrich your event with a delicious breakfast offer. These packages can be booked for 15 persons or more between 06.30 - 10.00 o'clock.

---

## BREAKFAST WORKSHOP AT CHF 36.00 PER PERSON

- Conference room (allocated by us)
  - Desired seating arrangement
  - 1 x beamer and 1 flipchart
  - Free WLAN
  - Breakfast buffet in the hall:
    - Coffee, tea and various fruit juices
    - Mineral water, plain and carbonated
    - Bread, rolls, croissants, rusks, toast and crispbread
    - Marmalade, honey, butter and margarine
    - Muesli/Flakes and yoghurt
    - Meat and cheese platter
    - Fruit salad, fruit basket and pastries
- 

## BREAKFAST WORKSHOP AT CHF 48.00 PER PERSON

- Conference room (allocated by us)
  - Desired seating arrangement
  - 1 x beamer and 1 flipchart
  - Free WLAN
  - Breakfast buffet in the hall:
    - Coffee, tea and various fruit juices
    - Mineral water, plain and carbonated
    - Bread, rolls, croissants, rusks, toast and crispbread
    - Marmalade, honey, butter and margarine
    - Muesli/Flakes and yoghurt
    - Meat and cheese platter
    - Scrambled eggs and breakfast eggs
    - Fried bacon and chipolata sausages
    - Röstli
    - Fruit salad, fruit basket and pastries
- 

### Questions?

Do not hesitate to contact our Congress-Team: Tel. +41 31 329 96 06 or [info@kongresszentrumkreuz.ch](mailto:info@kongresszentrumkreuz.ch)

# PARTNER COMPANIES

In addition to the Congress Centre Kreuz, the Hotel Kreuz and the Restaurant Bärenhöfli also belong to the Hotel Kreuz Bern AG and round off our range of services in a perfect way. Reservations for hotel rooms or table reservations in connection with your event can be made directly at the congress office. Organise your event, including additional services, with just one contact person who will look after and support you in all matters.



## Hotel Kreuz Bern

You need accommodation for your speakers or workshop participants? Work and relax under the same roof: The guests of the Congress Centre Kreuz have 97 comfortable hotel rooms in a prime location in the centre of Berne at their disposal.

## Restaurant Bärenhöfli

The cosy in-house restaurant Bärenhöfli is located on the ground floor of our beautiful, traditional building. Here you will find Bernese specialities and light lunch menus in equal measure. Our kitchen team will serve you a wide variety of traditional Bernese dishes all day long. You can also enjoy vegetarian and vegan dishes and changing seasonal specialities.



Enjoy our coffee and tea specialities, mocktails, desserts and the legendary Öpfuchüechli in the cosy lounge area. In our meeting niches you can discuss and work undisturbed. Ideal as a business meeting place in the middle of the city of Bern - and practical due to the free WLAN and electricity.

### Questions?

Do not hesitate to contact our Congress-Team: Tel. +41 31 329 96 06 or [info@kongresszentrumkreuz.ch](mailto:info@kongresszentrumkreuz.ch)



# ARRIVAL / CENTRAL

Our beautiful old town house is just a few steps away from the main railway station and the Federal Parliament. Are you interested in a shopping trip under the historic arcades after the event or in the diverse cultural offerings of the city of Bern? Almost everything is within a walking distance. A public car park (Metro Parking) is right next door.

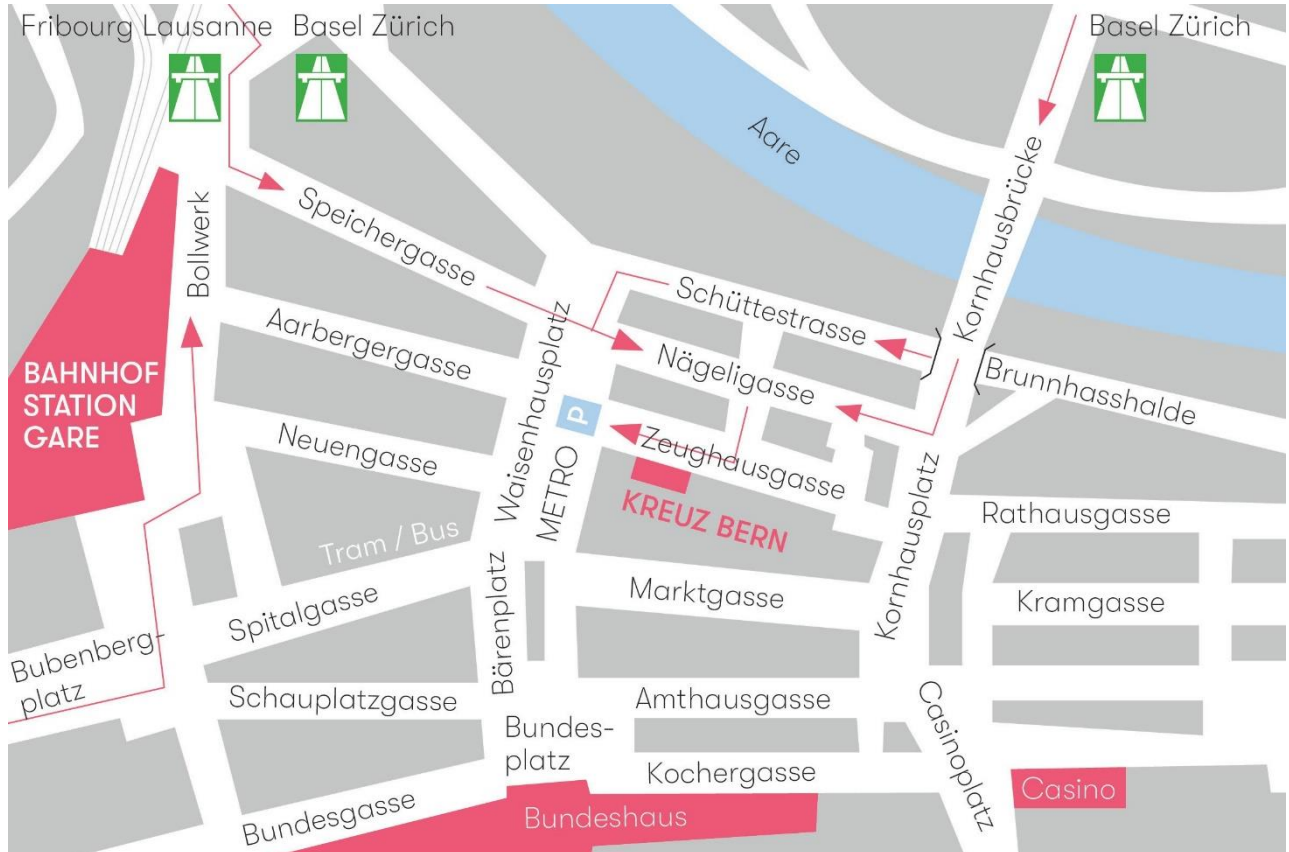

## PUBLIC TRANSPORT

- 5 minutes by foot from Bern main station
- next tram stop: Bärenplatz (tram 6/7/8/9, bus 12)  
The tram stop is 2 minutes away from the Congress Centre

## CAR

- nearest parking garage: Metro Parking, Waisenhausplatz 19, [www.metro-parking.ch](http://www.metro-parking.ch)
- You can find more car parks at [www.parkingbern.ch](http://www.parkingbern.ch)

## Questions?

Do not hesitate to contact our Congress-Team: Tel. +41 31 329 96 06 or [info@kongresszentrumkreuz.ch](mailto:info@kongresszentrumkreuz.ch)